

# 35mm Poles Apart IDC Semi-Complete Pole Fixing Instructions

Please read carefully before commencing

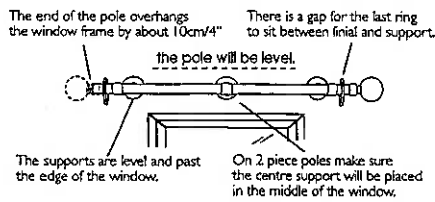

**Tools Required**

Drill

6mm Drill Bit

Screw Driver

Hack Saw

Spirit level

Tape Measure

**All measurements are approximate.**

Additional wall screws and plugs other than those enclosed in this pole set may be required depending on the mounting surface. Wallboard and plaster require the use of anchors such as expansion/toggle bolts. Brick, tile and stone require special plugs and drill bits. Remember to always pre-drill holes in wood to avoid splitting.

Parts List						
Pole Length	Pole	Pole Connector	IDC Brackets	Lined Rings	Wall Screws & Plugs	Allen Key
150cm	1 x 150cm	0	2	20	6	1
200cm	1 x 200cm	0	2	20	6	1
300cm	2 x 150cm	1	3	30	9	1
400cm	2 x 200cm	1	3	40	9	1

- 1** Remove the back plate from the brackets by turning the back plate until it detaches from the bracket.

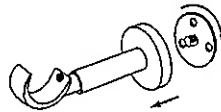

- 2** Mark & drill the bracket fixing positions, making sure they are level.

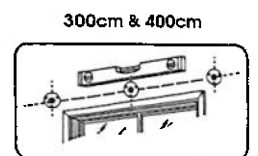
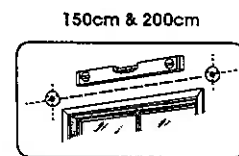
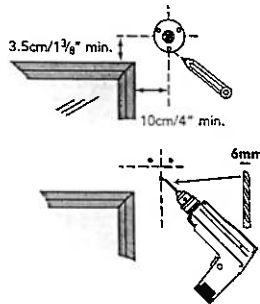

- 3** Fix the screws into the wall leaving a small section protruding from the wall.

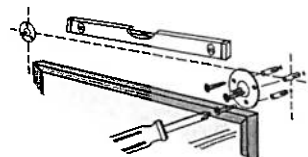

- 4** (A) Attach the IDC brackets onto the back plates. Line up the bracket with the screw on the back plate and turn the bracket until the bracket is secure.

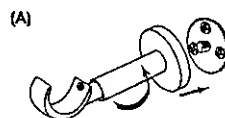

(B) To adjust the projection of the brackets, loosen the grub screw underneath the brackets using an allen key. Once loose, the bracket can be extended and secured into place by tightening the grub screw.

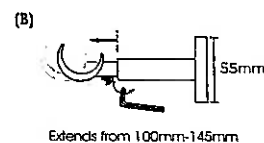

# 35mm Poles Apart IDC Semi-Complete Pole Fixing Instructions

Please read carefully before commencing

## Trimming a single pole - 150cm & 200cm

ONLY TRIM THE CURTAIN POLE IF IS NECESSARY.

- 5 (A) Measure & mark the length of pole you need to remove on one side of the pole. Using a hacksaw cut the pole and dispose of the excess pole piece.



## Trimming double poles - 300cm & 400cm

(B) Measure & mark the length of pole you need to remove. Using a hack saw trim an equal amount from each end of the pole, dispose of the excess pole pieces. Place the factory cut ends at the centre where you pole join will be.

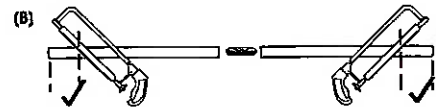

## Fixing single poles - 150cm & 200cm

- 6 Fixing the pole to the brackets.

(A) Slide the curtain rings onto the pole. Hang the pole onto the IDC brackets. Make sure the last ring at each end of the pole is placed after the bracket.

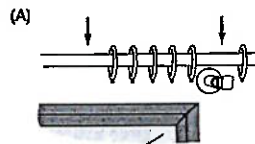

(B) Secure the pole to the brackets with the screw behind the bracket cup.

### FINIALS ARE SOLD SEPARATELY

Place the finials over the end of the pole & tighten the grub screws with an allen key.

Some finials are push on and therefore are secured to the pole by pushing the end into the pole.

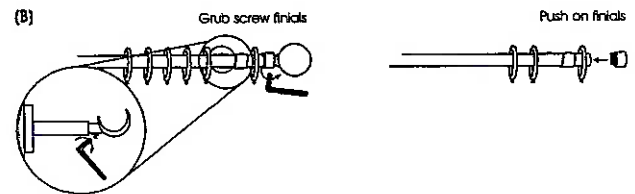

## Fixing double poles - 300cm & 400cm

- 7 Fixing the pole to the brackets.

(A) Insert the pole connector into the first pole and push the second pole onto the connector and into place. Both poles should now be attached together.

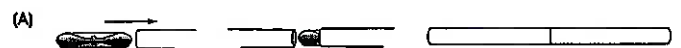

(B) Slide the curtain rings onto the pole. Hang the pole onto the IDC brackets. Make sure the centre bracket covers the centre join of the curtain pole & the last ring at each end of the pole is placed after the bracket.

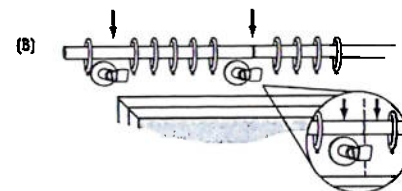

(C) Secure the pole to the brackets with the screw behind the bracket cup.

### FINIALS ARE SOLD SEPARATELY

Place the finials over the end of the pole & tighten the grub screws with an allen key.

Some finials are push on and therefore are secured to the pole by pushing the end into the pole.

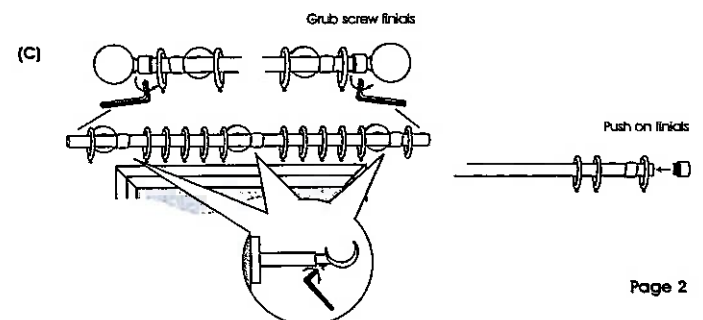

Illustrations are intended as a guide only.  
Component design/style may vary.  
LB0050