

28mm 67cm Bay Pole Corner Connector Fixing Instructions

Please read carefully before beginning this installation

We recommend a professional or a person competent in DIY undertake this installation.

WARNING!

Be careful when bending the corner connector.

The pre-cut metal slits on the pole close tight when bending. To avoid injury or damage to your clothes do not cover the slits when bending.

Bending the corner connector

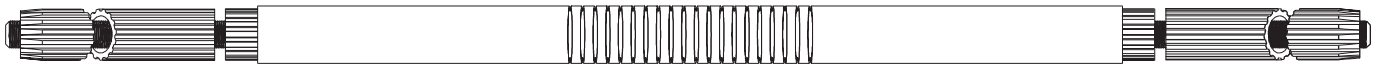

WARNING!

You must only bend the corner connector with the pre-cut slits to the inside of the bend. **NEVER** bend the corner connector with the slits on the outside of the bend.

Ensure the cuts are to the inside of the bend.

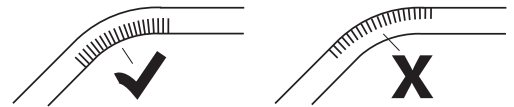

Bend the pole in the direction of the slats.

Before you begin to bend the corner connector, here's a practical tip.

You could use your knee to ease the bending process, as this helps to generate a smooth bend. Gently spread pressure throughout the length of the bend.

Working from the centre of the bend, gently and slowly bend the corner connector slightly into the arrow positions shown on the diagram until you reach your required angle.

Keep checking the fit of the bend as you go.

Max bend radius is 90 degrees.

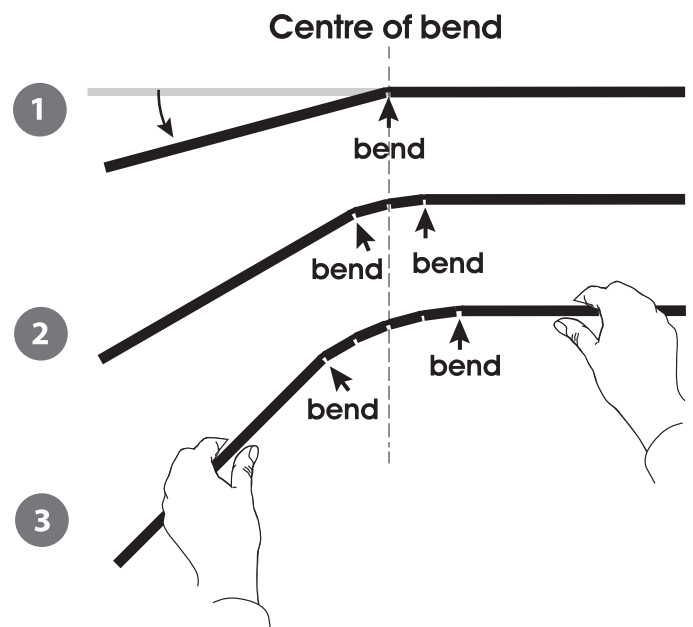

Attaching the corner connector to the curtain poles

Ensure that the corner connector ends are all in a straight line. They must not be twisted out of place.



Push your curtain pole onto the end of the corner connector until the internal connection is no longer visible and the two pole pieces meet flush together.

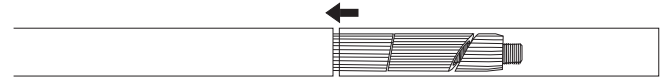
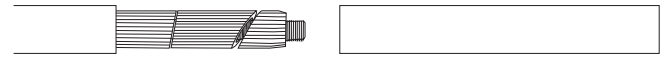

To lock the curtain pole in place into the corner connector you must hold each side of the join and twist.

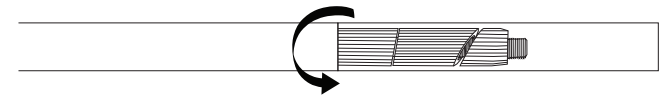

This diagram shows how the internal connection locks tightly inside the pole to secure the pole onto the corner connector.

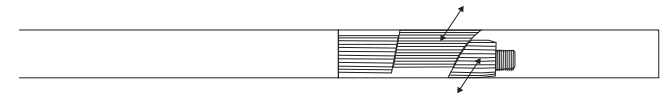

Your pole and corner connector are now attached ready for mounting into your bay window.

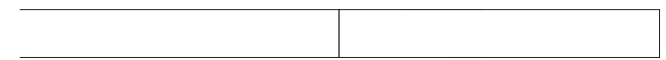

Please note: If you are using tube wall supports you may need to slide the curtain pole through the supports before you connect the corner connector.

